

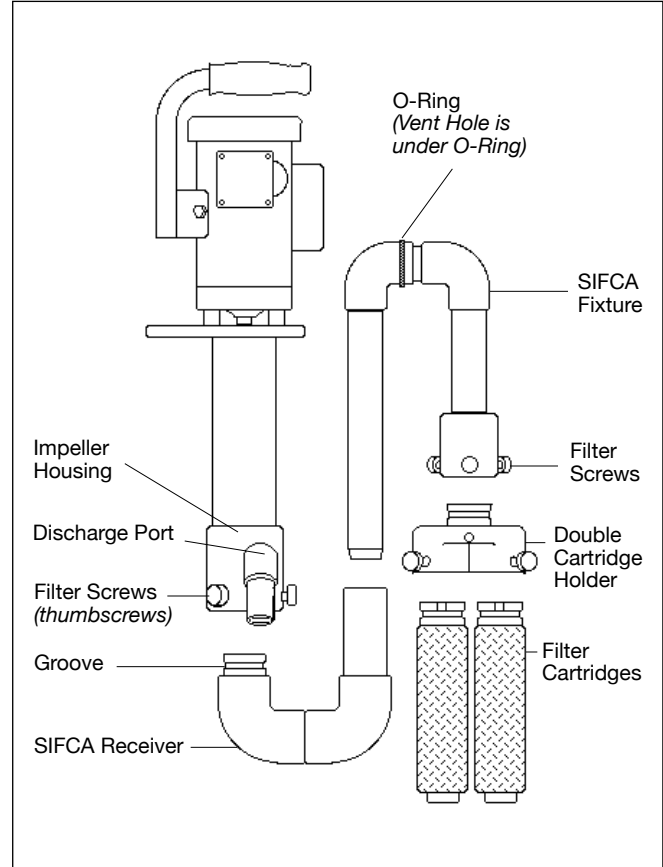

INSTRUCTIONS FOR INSTALLING FLO KING SLIDE-IN FILTER CARTRIDGE ADAPTER (SIFCA)

1. Loosen Filter Screws on pump and insert SIFCA Receiver into Impeller Housing.
2. Make sure Filter Screws are properly seated in groove of SIFCA Receiver, then tighten snugly by hand (do not overtighten with tools).
3. Install pump, with SIFCA Receiver attached, on tank to be filtered.
4. If desired, insert Double or Quad Cartridge Holder into SIFCA Fixture. Then tighten Filter Screws onto Fixture. (Alternatively, insert one filter cartridge directly into SIFCA Fixture.) Carbon Bag, Carbon/Resin Canister, In-Tank Floating Skimmer and other Flo King accessories should also be mounted onto SIFCA Fixture at this time.
5. Use thumb to pull back O-Ring on SIFCA Fixture, thus exposing Vent Hole.
6. With Vent Hole still exposed, lift SIFCA Fixture, insert into SIFCA Receiver, and push down slowly. *Note: Exposure of Vent Hole is required to bleed air from SIFCA assembly. You can feel air escaping by putting your hand over the Vent Hole while installing SIFCA Fixture.*
7. When all air has escaped, release O-ring and re-position over Vent Hole.
8. Turn pump on. SIFCA will normally prime in a few seconds and filtration will begin.



IF PUMP WILL NOT PRIME

1. This usually indicates that air is still trapped in the SIFCA assembly. Check again to make sure that SIFCA Receiver is properly seated in groove of pump Impeller Housing and that Filter Screws are tightened snugly.
2. Repeat Steps 5 and 6 above, making sure that ALL air is released from assembly and that O-ring is properly seated to completely re-cover Vent Hole afterwards.
3. If SIFCA still will not prime, try coarser filter cartridges (higher micron rating). Pump may be struggling to draw solution through filter cartridges if too tight for the application.
Note: SIFCA may be incompatible with some thick, high-specific-gravity solutions such as those used for electropolishing.